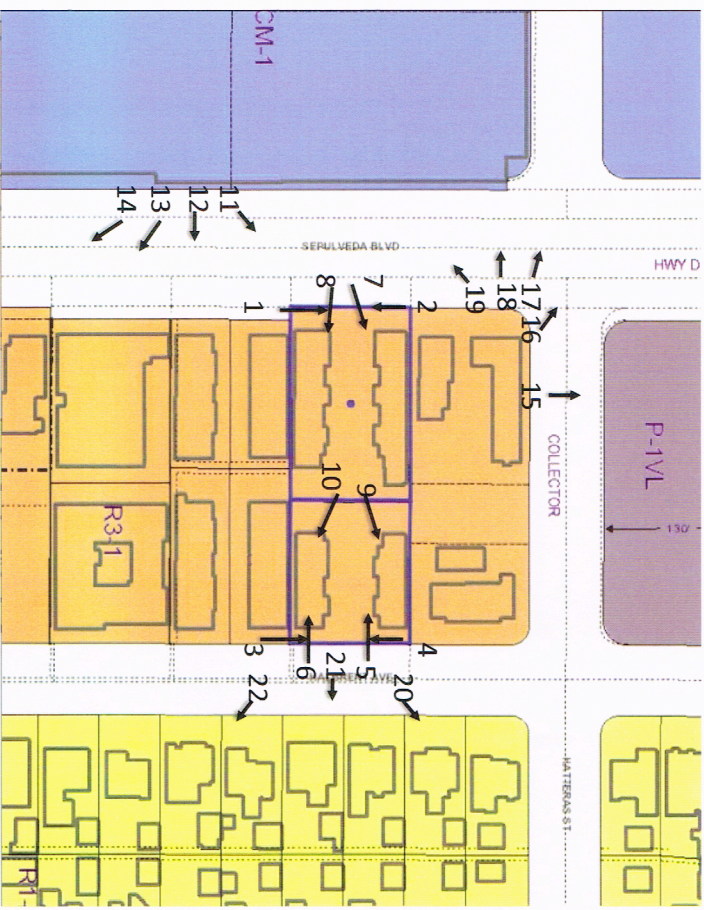

PHOTO KEY - La Quinta Inns & Suites: 5746-5750 N. Sepulveda Boulevard;
 5747-5751 N. Halbrent Avenue



1



2



1. View looking north across the Project Site's entrance driveway on N. Sepulveda Blvd.
2. View looking south across the Project Site's entrance driveway on N. Sepulveda Blvd.

3



4



3. View looking north across the Project Site's frontage on N. Halbrent Avenue.
4. View looking south across the Project Site's frontage on N. Halbrent Avenue.

5



6



5. View looking west across the northern half of the Project Site.
6. View looking west across the southern half of the Project Site.

7



8



7. View looking east across the northern half of the Project Site from the entrance driveway.
8. View looking east across the southern half of the Project Site from the entrance driveway.

9



10



9. View looking east across the northern half of the Project Site the from the center of the Project Site.
10. View looking east across the southern half of the Project Site the from the center of the Project Site.

11



12



11. View looking northeast across N. Sepulveda Blvd. at the Project Site.
12. View looking east across N. Sepulveda Blvd. at the 2-story apartment building south of the Project Site.

13



14



13. View looking east across N. Sepulveda Blvd. at the 2-story multi-family residential development south of the Project Site.

14. View looking south across N. Sepulveda Blvd. at the 3- and 4-story development south of the Project Site.



15



16

15. View looking north across Hatteras Street at the commercial shopping center/multi-story office building fronting onto N. Sepulveda Blvd.
16. View looking northwest across the intersection of Hatteras Street and N. Sepulveda Blvd. at the 8-story office building and associated surface parking.

17



18



17. View looking west across the intersection of Hatteras Street and N. Sepulveda Blvd. at the 8-story office building (right) and 6-level parking structure (left).

18. View looking west across N. Sepulveda Blvd. at the 6-level parking structure.

19



20



19. View looking southwest across N. Sepulveda Blvd. at the 6-level parking structure and multi-story Target store.

20. View looking northeast across Halbreth Avenue at the adjacent single family residential neighborhood.



21



22

- 21. View looking east across Halbreth Avenue at the adjacent single family residential neighborhood.
- 22. View looking southeast across Halbreth Avenue at the adjacent single family residential neighborhood.